

## 2/2-way Solenoid Valve for neutral media up to 356°F, NPT 1/2 - NPT 1

- Solenoid valve with servo-piston
- Temperatures up to 356°F (+180°C)
- For neutral media, incl. steam
- Push-over coil system
- Threaded and flange valve bodies

Type 0406 can be combined with...

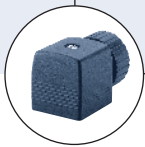

**Type 2508**  
Cable plug



**Type 1078**  
Timer unit

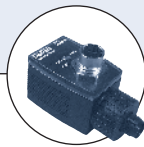

**Type 2511**  
ASI cable plug

Type 0406 is a pilot controlled solenoid valve with servo-piston and is suitable for media up to 356°F (+180°C). A minimum differential pressure of 14.5 PSI is required to fully open the valve.

The valve is closed by its own media pressure and spring force without power supply.

### Technical data

<b>Orifice</b>	DN 13 - 25
<b>Body material</b>	Brass, grey cast iron
<b>Coil material</b>	Epoxy
<b>Coil insulation class</b>	H
<b>Seal material</b>	PTFE/graphite
<b>Media</b>	Neutral media such as hot water and steam
<b>Media temperature</b>	14°F to 356°F (-10°C to +180°C)
<b>Ambient temperature</b>	max. 131°F (+55°C)
<b>Viscosity</b>	max. 21 cSt
<b>Voltage tolerance</b>	±10%
<b>Duty cycle</b>	100% continuous rating
<b>Electrical connection</b>	Cable plug for Ø 7 mm cable, acc. to DIN EN 175301-803 Form A (supplied as standard)
<b>Protection class</b>	IP 65 with cable plug
<b>Installation</b>	As required, preferably with actuator upright

### Power consumption

Orifice DN [mm]	Inrush AC [VA]	Hold (hot coil)	
		AC [VA/W]	DC [W]
13-25	21	12/8	8
32-40	35-40	16/12	–

## Ordering chart for valves (without cable plugs)

## All valves with PTFE and graphite-seal

Circuit Function	Orifice [inch]	Flow Rate		Port Connection [NPT]	Pressure Range [PSI]	Body Material	Seal Material	Approvals	Voltage/Frequency [V/Hz]	Order no.
		Water C <sub>v</sub> -Value [gpm]	Air Q/Nn [SCFM]							
A	1/2"	4.3	140	1/2	14-58	Brass	PTFE	UL/FM	24/DC	453 038
					14-174	Brass	PTFE	-	24/60	452 257
					14-174	Brass	PTFE	UL/FM	24/60	453 037
					14-174	Brass	PTFE	-	120/60	450 369
					14-174	Brass	PTFE	UL/FM	120/60	453 036
					14-174	Brass	PTFE	UR	120/60	453 773
					14-174	Brass	PTFE	-	240/60	450 426
					14-174	Brass	PTFE	UL/FM	240/60	US00949
	3/4"	5.8	190	3/4	14-58	Brass	PTFE	-	24/DC	452 258
					14-58	Brass	PTFE	UL/FM	24/DC	453 041
					14-174	Brass	PTFE	UL/FM	24/60	453 040
					14-174	Brass	PTFE	UR	120/60	453 774
					14-174	Brass	PTFE	UL/FM	120/60	453 039
					14-174	Brass	PTFE	UL/FM	240/60	US00948
	1"	11.7	380	1	14-58	Brass	PTFE	UL/FM	24/DC	453 043
					14-174	Brass	PTFE	UL/FM	24/60	453 042
					14-174	Brass	PTFE	UR	120/60	453 775
					14-174	Brass	PTFE	UL/FM	120/60	453 044
					14-174	Brass	PTFE	UL/FM	240/60	US02355
	1 1/4"	21	680	1 1/4	14-174	Brass	PTFE	-	120/60	453 900
	1 1/2"	21	680	1 1/2	14-174	Brass	PTFE	-	120/60	453 901

- CSA approval standard with all U.L. listed and recognized valves
- CE approval standard on all valves
- FM approved valves are approved for use in Class 1 Div 2 groups A, B, C, D, hazardous locations
- All U.L. listed valves include the Type 2509 series conduit plug

Dimensions [inches]

Ported Version

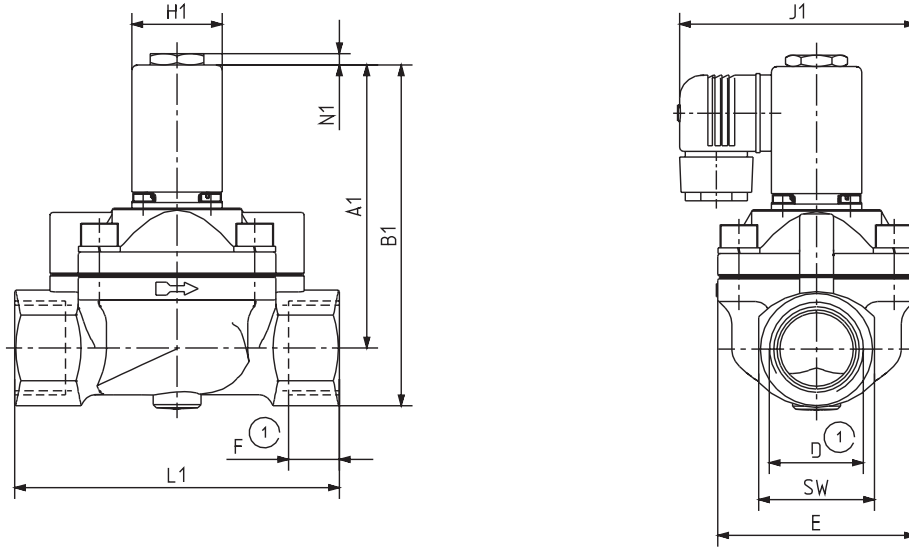

 U.L. Listed with conduit-plug  
Type 2509  
(0-250 V AC/DC)

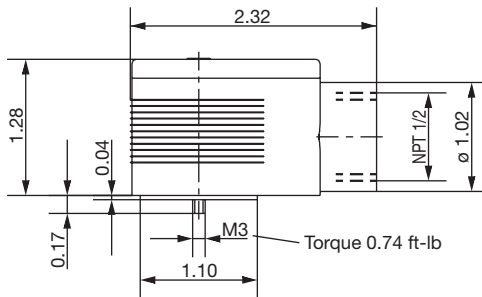
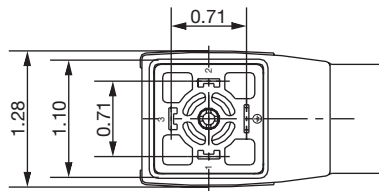

without circuitry

Orifice	Ported Version									
	A1	B1	D1 (NPT)	F1	E1	L1	SW	J1	H1	N1
1/2	3.70	4.30	1/2	.55	1.57	2.56	1.06	2.71	1.26	.16
3/4	3.70	4.37	3/4	.63	2.36	3.93	1.26	3.11	1.26	.16
1	3.95	4.76	1	.70	2.75	4.52	1.61	3.30	1.26	.16
1 1/4	5.50	6.53	1 1/4	.78	3.34	4.96	1.96	3.78	1.57	.35
1 1/2	5.70	6.89	1 1/2	.86	3.34	4.96	2.36	3.78	1.57	.35